

# FIRST FLOOR PLAN

SCALE 1:100

DRAWN	CHECKED	DATE	SCALE
O.N.	S.M.	MAR. 2015	1:100

DRAWING NUMBER		PROJECT NUMBER	DRAWING NUMBER	STAGE	REV
2013/J010		AR/DU-AL/201	CN	2	

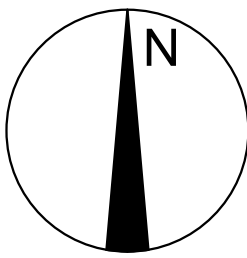
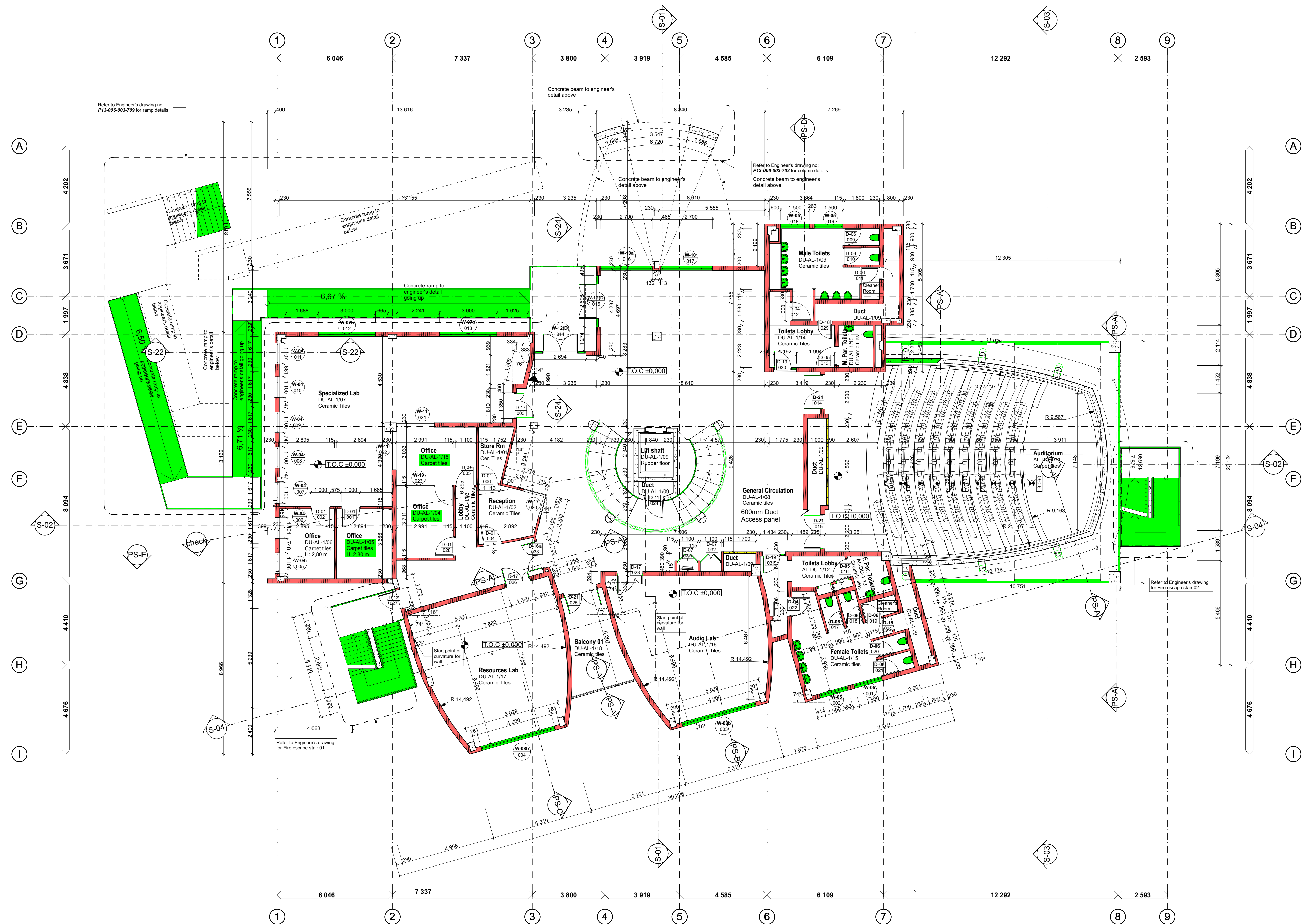

## NOTES

### GENERAL COUNCIL NOTES

1. Quality of workmanship to comply with the SABS 0400 and National Building Regulations; and with the minimum standards specified in the standard preambles in the bill of quantities.
2. Contractor to check all dimensions, levels, gradients and heights before commencing work. Any errors to be reported immediately to architect/engineer.
3. Contractor to identify and locate existing services on site and to protect these from damage for the duration of the works.
4. Contractor to build in 250 micron PVC Damp Proof Course (whether or not these are shown on the drawings) to all external walls at each floor, beam and parapet level and to all windows and doors, with cavity walls to have stepped DPC.
5. Drawings are not to be scaled.
6. Roof structure, and foundations to structural engineers detail.
7. Retaining walls to structural engineers detail.

### DRAINAGE AND PLUMBING

1. All drainage and plumbing work and installation of sanitary fittings to comply with National Building Regulations and the Plumbing Institute of South Africa.
2. Inspection eyes to be provided at all bends and junctions which are to be suitably marked at ground level.
3. Minimum fall of drains to be 1:40.
4. Approved resal traps to be provided at all waste fittings.
5. Inspection eyes at waste pipes to be accessible at all times.
6. Pipes are to be sized as follows: W/Bs, sinks- diam20mm; showers- diam50mm; WCs, soil pipes, vents and stacks- diam100mm.
7. diam100mm vent stack to be built into wall section.

### ELECTRICAL INSTALLATIONS

1. All electrical work to comply to National Building Regulations and SABS 0142.
2. All work to be done under the supervision of an electrician registered with the Electrical Contractors Association (SA)
3. Main Distribution Board to be built in wall (with isolator, earth leakage devices and circuit breakers)
4. Electrical Cables to be PVC armoured copper cables (SABS 0150).

NO	DATE	REVISION	SIGNED
A	04-02-2014	ISSUED FOR TENDER	
B	18-02-2014	INTERNAL WALLS AMENDMENT	
C	15-11-2014	INTERNAL WALLS & NOTES AMENDMENT	
D	14-04-2015	SITE HANDOVER	
E	02-12-2015	WINDOW AND DOOR DIMENSIONS	
F	05-04-2016	WALL PAINT COLOURS AND SPECIFICATION	
G	13-04-2016	DUCT ACCESS PANEL	

### CLIENT



### ARCHITECT

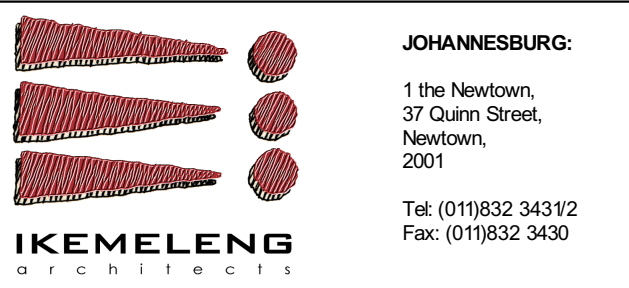

### PROJECT

**RECOGNITION WORK (AS BUILT)  
DISABILITY UNIT AND AFRICAN  
LANGUAGES CENTRE ON PORTION  
120 OF FARM LEEUWKUIL AND  
PORTION 71 OF FARM  
VANDERBIJLPARK FOR THE  
VAAL UNIVERSITY OF  
TECHNOLOGY  
VANDERBIJLPARK**

### DRAWING TITLE

**FIRST FLOOR PLAN**

DRAWN	CHECKED	DATE	SCALE
O.N.	S.M.	MAR. 2015	1:100

DRAWING NUMBER		PROJECT NUMBER	DRAWING NUMBER	STAGE	REV
2013/J010		AR/DU-AL/201	CN	2	